

## TurboCycler Lite Quick Operation Guide

Scan the QR code on page 8 to download the Operation Manual

### Hardware operation

1. To open the lid, pull the handle upward and lift the lid backward to the upright position.

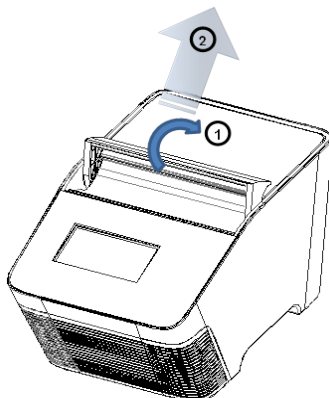

2. To close the lid, pull the lid downward and close the handle to the lock position.

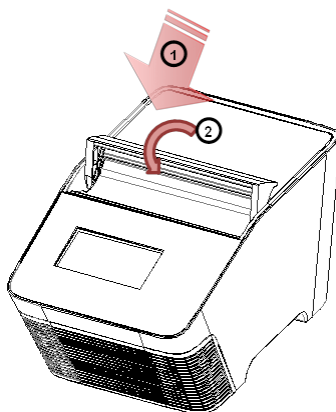

3. Lid heater setting:

PCR vessels	Compression mat	Lid heater temperature
Regular PCR plate, tube-strips and tubes	Not necessary.  The 1 mm compression mat can be used to help maintaining the sealing integrity in case the PCR plate has any imperfection on the rim of the well.	105 °C
Low profile PCR plate, tube-strips and tubes	The 5.2 mm compression mat must be used to ensure sufficient contact pressure from the heated lid.	120 °C

a. Instructions for applying the compression mat:

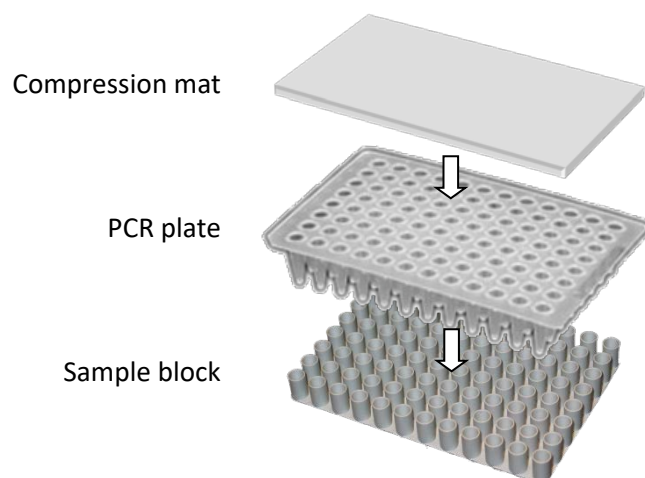

b. For detailed instructions on the lid heater setting, please refer to **section 3.4** of the TurboCycler Lite Operation Manual.

4. In order to prevent the deformation of the PCR vessels, and to ensure even distribution of the pressure from the lid, when PCR tubes or tube-strips are used, please load extra empty tubes on the 4 corners of the sample block. Always make sure that all the sample tubes/ tube-strips are distributed evenly on the sample block.

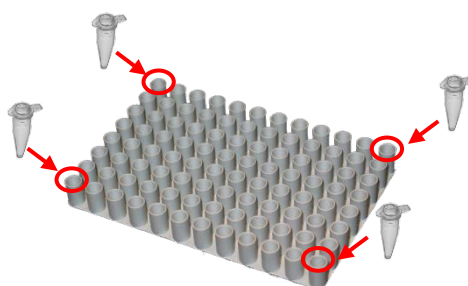

5. Ventilation air flow path:

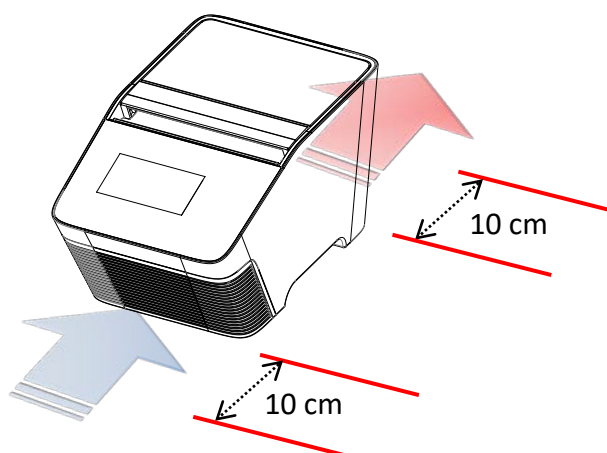

Please make sure there is no obstacle in the air flow path. At least 10 cm of space is required at the front and the back of the instrument.

## Software operation

### 1. Home Screen:

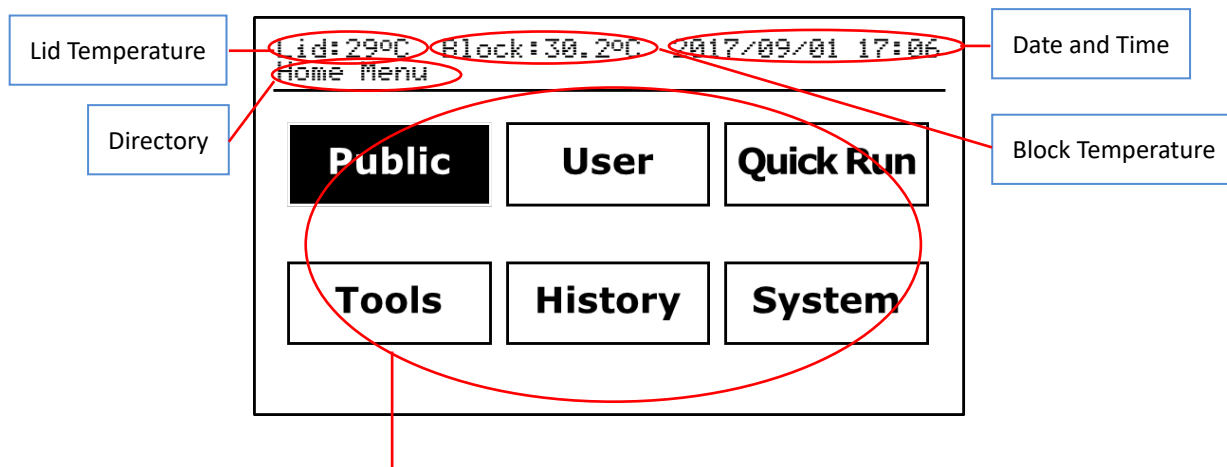

Home function icons	
<b>Public</b>	<b>Public folder</b> Shortcut to the Public folder
<b>User</b>	<b>User folder</b> For user folder management
<b>Quick Run</b>	<b>Quick Run</b> Quick access to the protocol editing and running without the need to create and save a new protocol
<b>Tools</b>	<b>Tools</b> Built-in assistant tools
<b>History</b>	<b>History</b> Protocol run history logbook
<b>System</b>	<b>System setting</b> For system management

## 2. Keypad

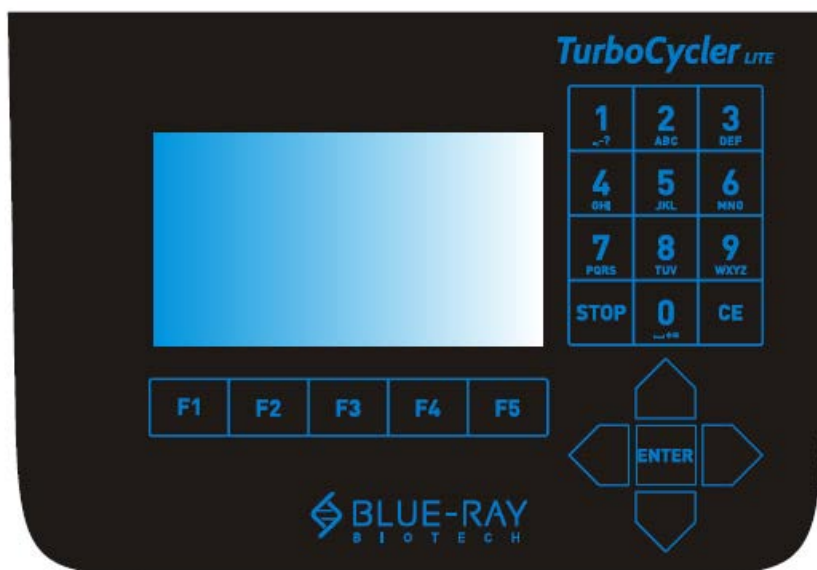

Key	Key Representation
1	1 . , - ? ' # : ; /
2	2 A B C a b c
3	3 D E F d e f
4	4 G H I g h i
5	5 J K L j k l
6	6 M N O m n o
7	7 P Q R S p q r s
8	8 T U V t u v
9	9 W X Y Z w x y z
0	0 _ + = < > & ( ) %
STOP	Stop the protocol running
CE	Cancel input and back space
▲ ▼ ◀ ▶	Selection keys
ENTER	Confirm the selection or input
F1 ~ F5	Function keys

### 3. User folder management:

On the main screen, select User to enter the user folder management section.

Lid:25°C Block:25.0°C
2017/09/01 17:06

User Menu
1/1

---

[Quick Run]

[Public]

\* User 1

User 2

User 3

User 4

User 5

User 6

\* User 7

User 8

User 9

User 10

---

HOME
NEW
EDIT
REMOVE
OPEN

F1

F2

F3

F4

F5

User folder management		
F1	<span style="border: 1px solid black; padding: 2px 10px;">HOME</span>	Return to main menu
F2	<span style="border: 1px solid black; padding: 2px 10px;">NEW</span>	Create a new user folder
F3	<span style="border: 1px solid black; padding: 2px 10px;">EDIT</span>	Edit the selected user folder name
F4	<span style="border: 1px solid black; padding: 2px 10px;">REMOVE</span>	Remove the selected user folder
F5	<span style="border: 1px solid black; padding: 2px 10px;">OPEN</span>	Open the selected user folder

#### 4. Protocol management:

Open the selected user folder. The protocol file list will be displayed.

Lid:25°C		Block:25.0°C		2017/09/01 17:06	
User: 1				01/01	
Protocol 1		2017/10/20 13:50:12			
Protocol 2		2017/10/23 14:15:12			
Protocol 3		2017/10/25 15:16:17			
Protocol 4		2017/11/02 11:12:13			
<div> <div>BACK</div> <div>NEW</div> <div>EDIT</div> <div>REMOVE</div> <div>OPEN</div> </div>					
F1		F2		F3	
F4		F5			

Protocol management		
F1	BACK	Return to user folder list
F2	NEW	Create a new protocol file
F3	EDIT	Edit the selected protocol file name
F4	REMOVE	Remove the selected protocol file
F5	OPEN	Open the selected protocol file

## 5. Protocol editing:

- Refer to “**Section 4. Protocol management**” to open the protocol.

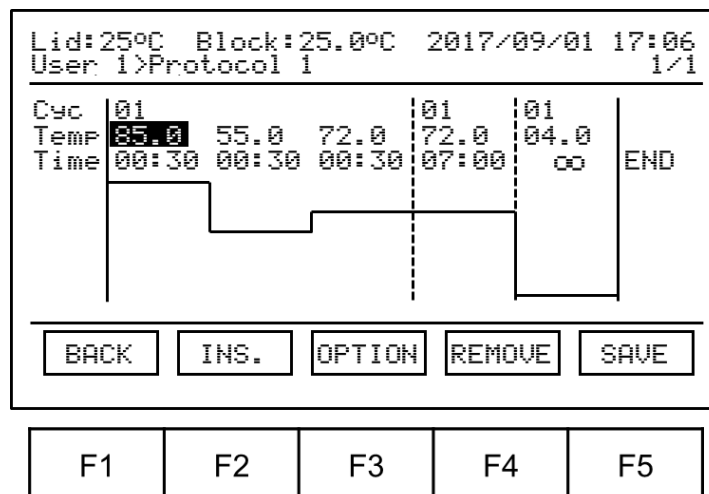

Protocol editing		
F1	BACK	Return to protocol list
F2	INS.	Duplicate the selected stage or step
F3	OPTION	Edit the advanced step options
F4	REMOVE	Remove the selected stage or step
F5	SAVE	Save the edited protocol
	RUN	Run the protocol

- Use the ◀ ▶ keys to select the step segment; use the ▲ ▼ keys to select the field you want to modify. The selected area will be highlighted.
- Use the alpha-numeric keypad to input the setting value for the selected field.
- Tap **SAVE** to save the changes.

## 6. Running a protocol:

- Refer to “**Section 4. Protocol management**” to open the protocol.
- Tap **F5**  to initiate the run.
- Specify the lid heater temperature.

Lid: 29°C Block: 30.2°C 2017/09/01 17:06  
[Public]>22

Lid : OFF °C (35~120, 0:OFF)  
Volume : 020 ul (10~100, 0:Block Mode)

F1

F2

F3

F4

F5

- Key in the sample volume.

Lid: 29°C Block: 30.2°C 2017/09/01 17:06  
[Public]>22

Lid : OFF °C (35~120, 0:OFF)  
Volume : 020 ul (10~100, 0:Block Mode)

F1

F2

F3

F4

F5

- Tap **F5**  to start the run.



## 7. Tools:

<b>Dry Bath</b>	Use the TurboCycler Lite as a dry bath
<b>Tm Calculator</b>	Calculate the Tm for the input primer
<b>OD Convertor</b>	Calculate the nucleic acid concentration from an OD measurement
<b>Copy Number Convertor</b>	Convert the DNA concentration to a copy number
<b>Mastermix Preparation Wizard</b>	Calculate the volume of the reagents needed to make the mastermix

## 8. System:

<b>Administrator</b>	System Administration
<b>Ramping Rate</b>	Change the system ramp rate
<b>Key Beep</b>	Turn the system keypad buzzer on/off
<b>Date &amp; Time</b>	Change the system date and time

## Note:

1. The content of this document is subject to change without prior notice. Please visit Blue-Ray Biotech's website at [www.blue-raybio.com](http://www.blue-raybio.com) for updated information.
2. If you have any questions about the operation of the TurboCycler Lite, please contact [sales@blue-raybio.com](mailto:sales@blue-raybio.com) for assistance.
3. Scan the QR code to access the product website and the operation manual.



Product Website



Operation Manual